



# Maule Aircraft Corporation

SPENCE AIR BASE

PHONE (912) 985-2045

MOULTRIE, GEORGIA 31768

4, September 1969

Service letter # 19

Models Affected M-4, M-4-210, M-4-220 S,T, & C  
Serial No's M-4-1T thru 3T, 1C thru 11C, 3 thru 94  
and 1S thru 3S M-4-210 1001 thru 1045, 1001C thru  
1075C and 1079C and 1080C, M-4-220, 2001C thru 2029C and  
2032C, 2001S

Dear Customer:

It has become necessary to issue Service Letter #19  
on all models produced by Maule Aircraft Corporation.

We have discovered a possibility that the pulley on the  
lower control column could come off the pulley bearing if  
the bearing didnot have the proper press fit in the pulley.  
This is a mandatory item and must be complied with at your  
earliest convenience.

Please find enclosed instructions and bill of material  
needed for compliance.

Sincerely yours

MAULE AIRCRAFT CORPORATION

B. D. MAULE  
PRESIDENT

Enclosures

BDM/jm

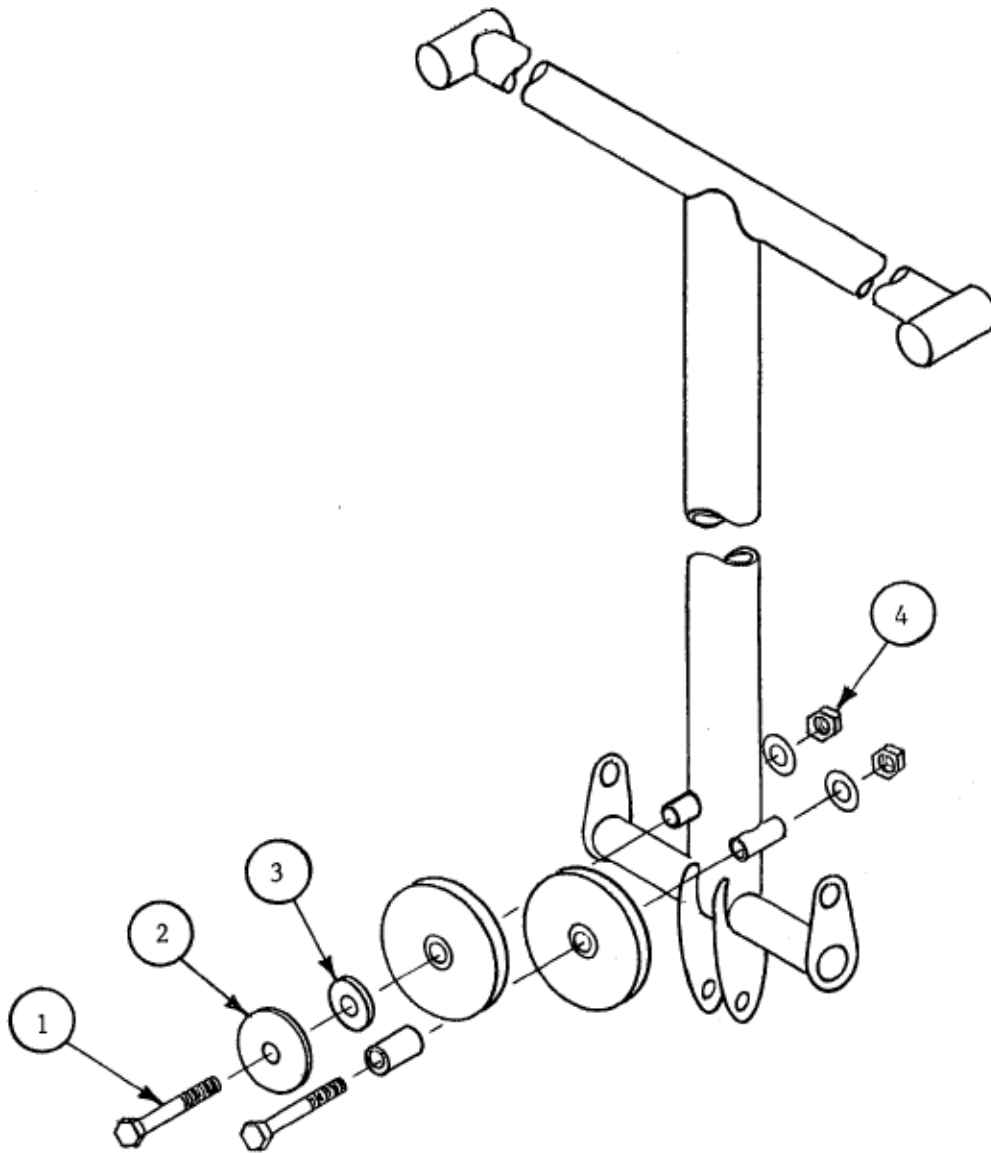
SERVICE LETTER #19CONTROL COLUMN ASSY

REF. NO.	PART NO.	REQ.	DESCRIPTION
1	AN5-27	1	BOLT
2	AN970-5	1	WASHER
3	AN960-516	1	WASHER
4	AN365-524	1	NUT

# MAULE AEROSPACE TECHNOLOGY, INC.

## SERVICE LETTER #19 - COMPLIANCE RECORD

Airplane Serial Number \_\_\_\_\_

Airplane Registration Number \_\_\_\_\_

The following action was taken with respect to this service letter:

Service letter #19 completed

Certified by \_\_\_\_\_

(Signature)

\_\_\_\_\_  
(Printed Name)

Title \_\_\_\_\_

(Owner, A&P), IA, etc.)

In an effort to keep our mailing list current for sending Service Letters, Service Bulletins, etc., please fill in the following:

Owner's name \_\_\_\_\_

Owner's address \_\_\_\_\_

Mail this Compliance Record to:      Maule Aerospace Technology, Inc.  
Engineering Records  
2099 GA Hwy. 133 S.  
Moultrie, GA 31788